

# Tanque Séptico

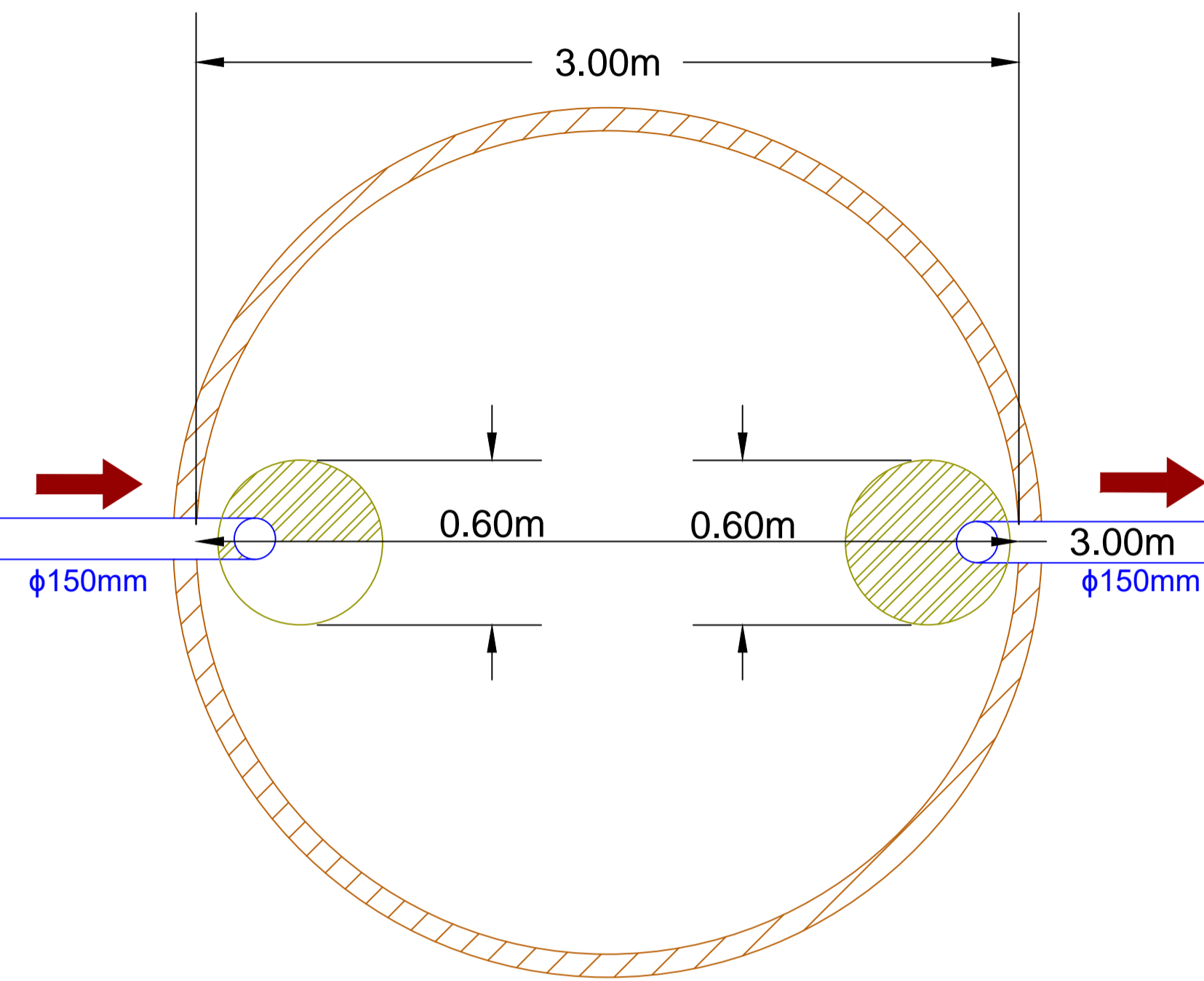

# Filtros Anaeróbios

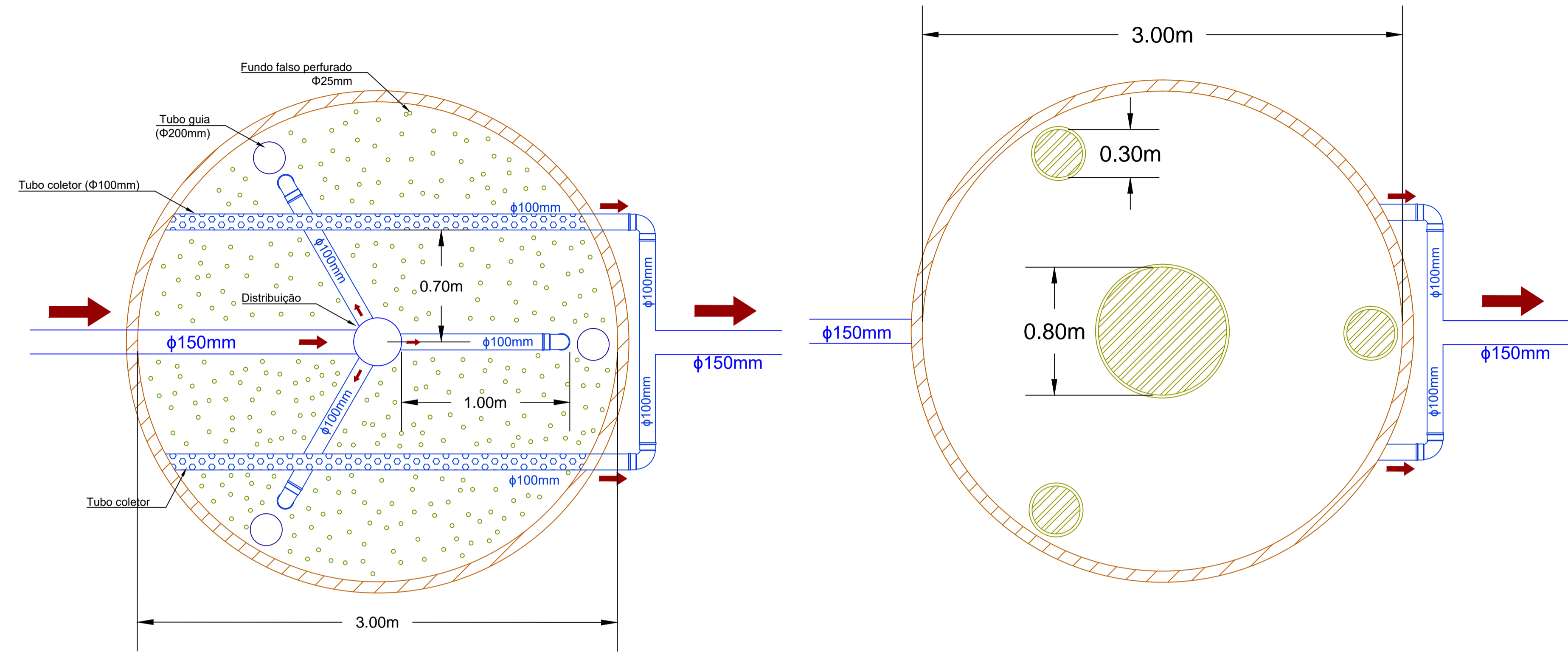

# Corte A-A'

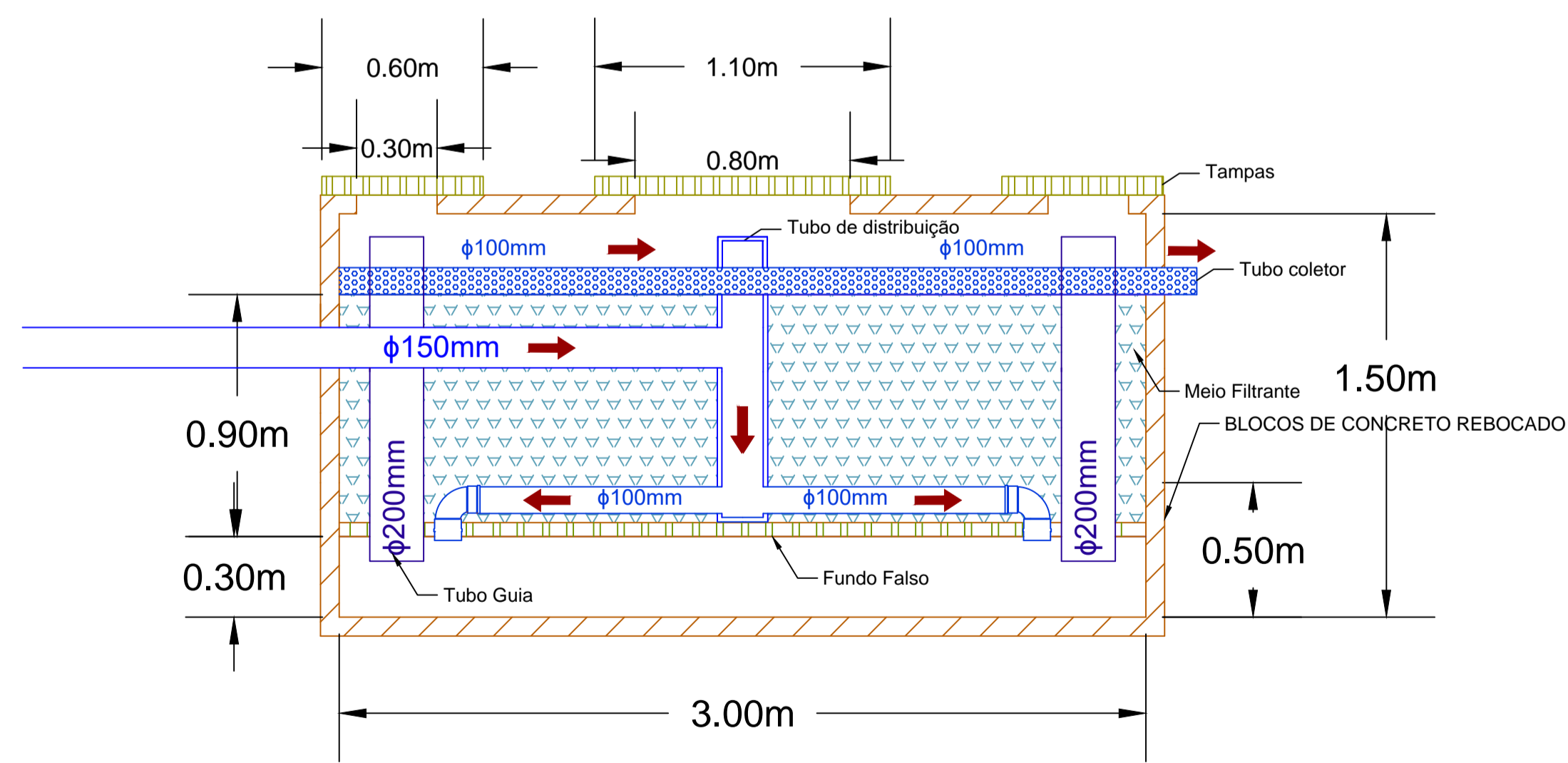
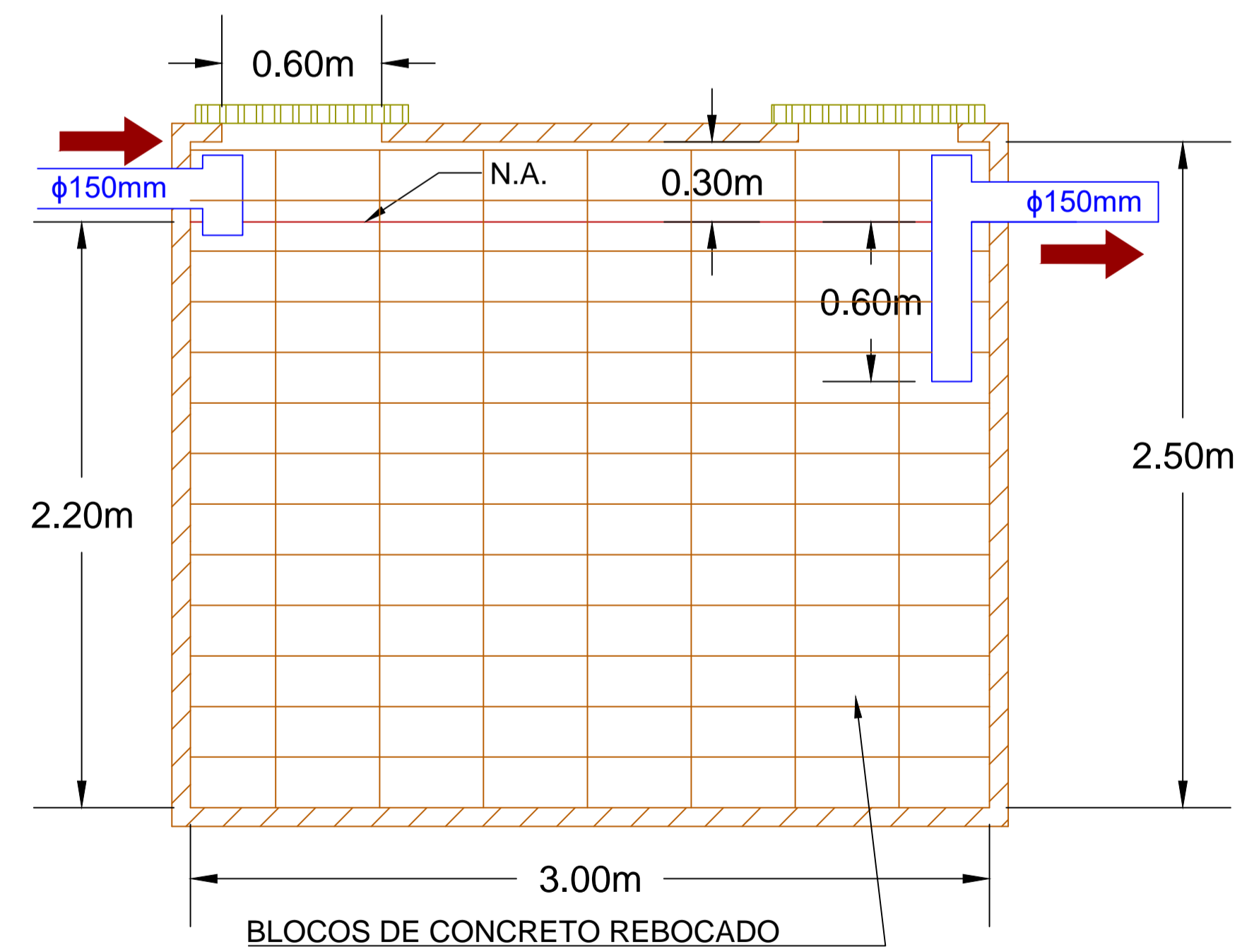

		CIMCATARINA CONSÓRCIO INTERMUNICIPAL CATARINENSE	
Sistema de Esgotamento Sanitário - Tanque Séptico e Filtros Anaeróbios			
Local:	Loteamento Bairro Britador/SC	Responsável Técnico:	<i>Maruam Karim Alemsan</i>
Coordenadas:		Escala:	1:20
Prancha:	A1	Folha:	Data: ABRIL/2018
MARUAN KARIM ALEMSAN ENGENHEIRO SANITARISTA E AMBIENTAL CREA-SC. 149616-9			